



OAKSIDE APARTMENT
BY CONVICITY

A Project of:
Bloomsbury Infrastructure Pvt. Ltd.



Facilities & Amenities:



Gymnasium*



Community Hall*



Indoor Games*



CCTV Cameras



Power Backup

Specifications:

Structure

- RCC framed structures.

Flooring

- 4x2 Vetrified Tiles.

Staircase

- Marble Finish.

Toilets

- Anti-skid Vetrified Tiles.
- 5'ft dado with Tiles.
- Western Commode.
- Stainless Steel fittings.

Kitchen

- Anti-skid Vetrified Tiles.
- Kitchen platform with Granite.
- 3'ft dado with Tiles.
- Stainless Steel Sink.

Doors & Windows

- Aluminium framed sliding Windows.
- Glass fitted.
- Flush doors with wooden frame.

Electricals

- Copper wiring with MCB.
- Modular switches.
- AC points in all Bedrooms.
- Gyser point in Toilet.

Others

- 5 Passenger Lift.
- Driveway hard surface.

*Optional Amenities.

Typical Floor Plan:

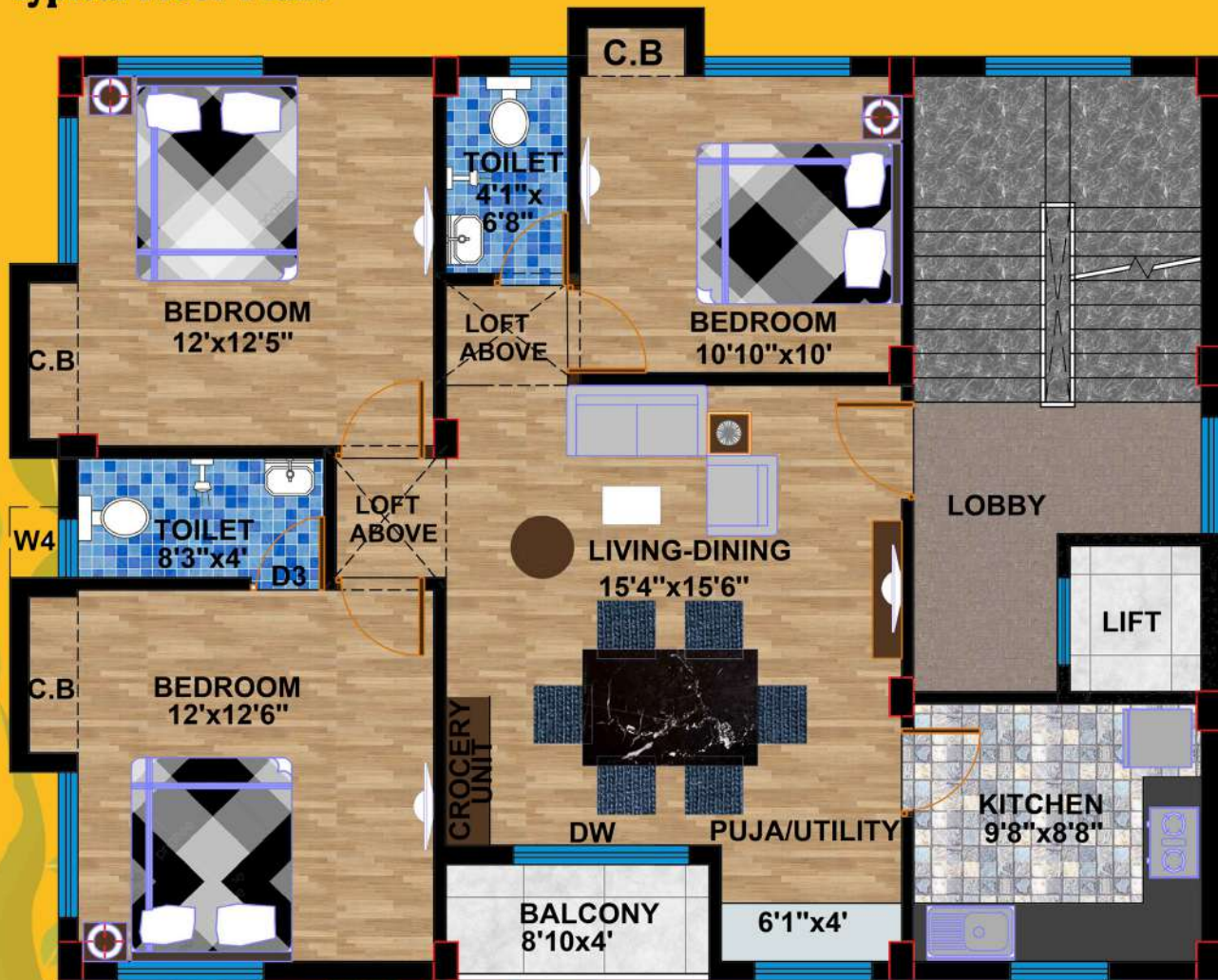

Ground Floor Plan:



**Built-up Area:
1400 Sq.ft.**

**Super Built-up Area:
1750 Sq.ft.**

**Car Parking:
125 Sq.ft.**

Location Map:

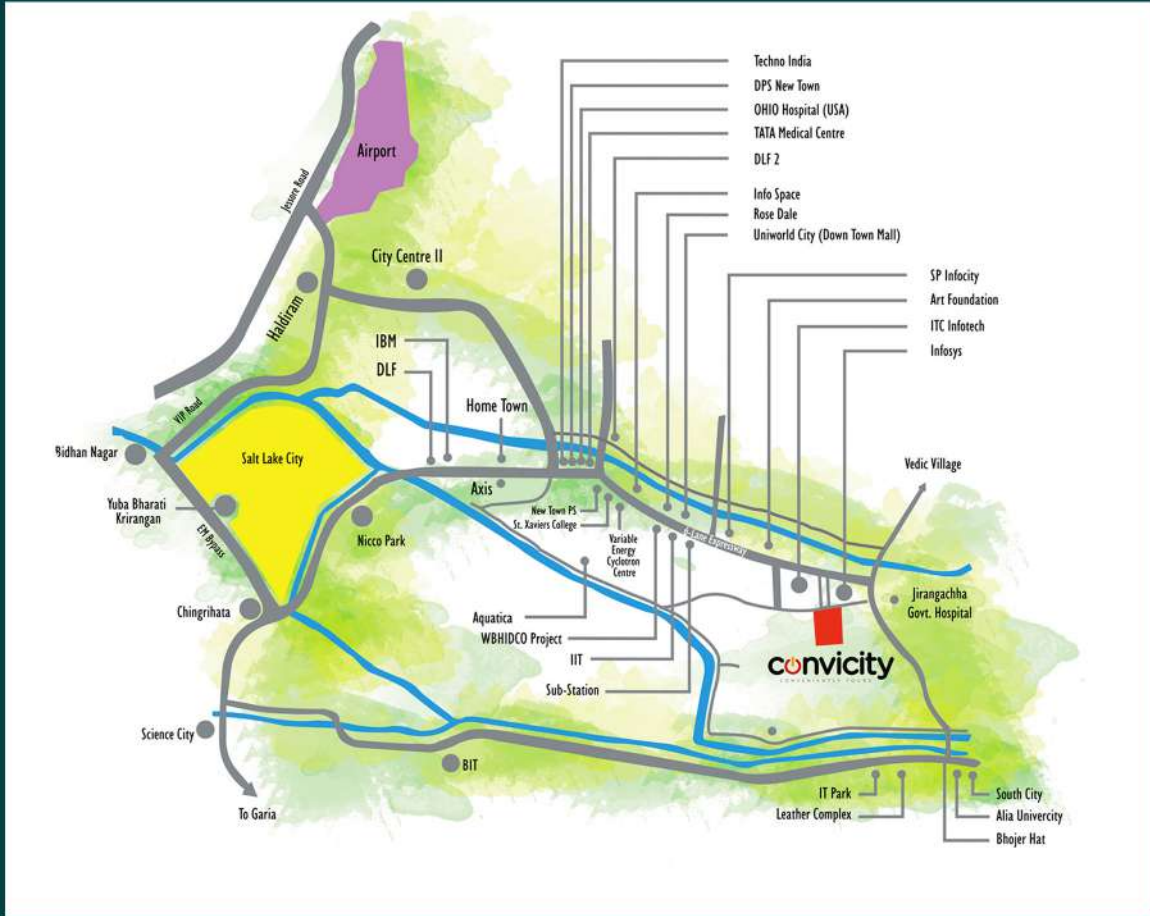

Mouza-Hatishala, P.S. Kolkata Leather Complex, Dist: South 24 Parganas.

- Site to Technopolis - 15mins
- Site to Biswa Bangla Gate - 10mins
- Site to Airport - 30mins
- Site to Science City - 25mins

Corporate Office:

Bloomsbury Infrastructure Pvt. Ltd.
Martin Burn i-Space I, 3rd Floor, DH-6/35,
Street No-315, Newtown, Action Area-I,
Kolkata-700 156.

Call: +91 8777617069 , +91 6289346024

Developed By:



www.convicity.in