

**convicity**  
CONVENIENTLY YOURS

1.5 Katha

3 Katha

Venture into a new Furture..!!





## Facilities & Amenities: Specifications:

- 🔌 Gated Community
- 🔌 Security Service
- 🔌 CCTV Cameras
- 🔌 Power Backup
- 🔌 Ambulance
- 🔌 Club House
- 🔌 Banquet Hall
- 🔌 Gymnasium
- 🔌 Swimming Pool
- 🔌 Childrens Play Area
- 🔌 Park, Garden
- 🔌 Mini Lake

🔌 **Structure**  
RCC framed structures.

🔌 **Flooring**  
3x3 Vetrified Tiles.

🔌 **Staircase**  
Marble Finish.

🔌 **Toilets**  
Anti-skid Vetrified Tiles.  
5'ft dado with Tiles.  
Western Commode.  
Stainless Steel fittings.

🔌 **Windows**  
Aluminium framed sliding Windows.  
Glass fitted.  
Flush doors with wooden frame.

🔌 **Kitchen**  
Anti-skid Vetrified Tiles.  
Kitchen platform with Granite.  
3'ft dado with Tiles.  
Stainless Steel Sink.

🔌 **Electricals**  
Copper wiring with central MCB.  
Modular switches.  
AC point in Bedroom.

🔌 **Others**  
Parking Space hard surface.

2 Katha





**Master Layout**



**Ground Floor**



**First Floor**



**Land Area- 1.5 Katha (1080 Sq.ft)  
Built Up Area- 895 Sq.ft.**

**Ground Floor**



**First Floor**

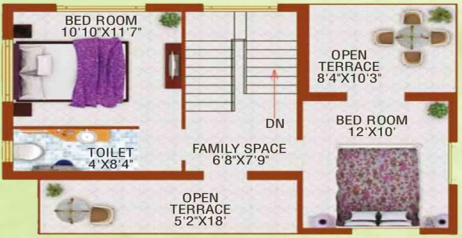

**Land Area- 2 Katha (1440 Sq.ft)  
Built Up Area- 1265 Sq.ft.**

**Ground Floor**



**First Floor**



**Land Area- 3 Katha (2160 Sq.ft)  
Built Up Area- 1872 Sq.ft.**



## Location Map:

Convicity, at New Town area, Rajarhat is well-connected to all prime landmarks of the city.

- Only 5mins from NewTown (Narkelbagan)
- 7mins from HomeTown Mall
- 12mins from Sector V , Salt lake
- 20mins from City Centre II Rajarhat
- 25mins from Chingrighata & Airport
- 30mins from Baguihati

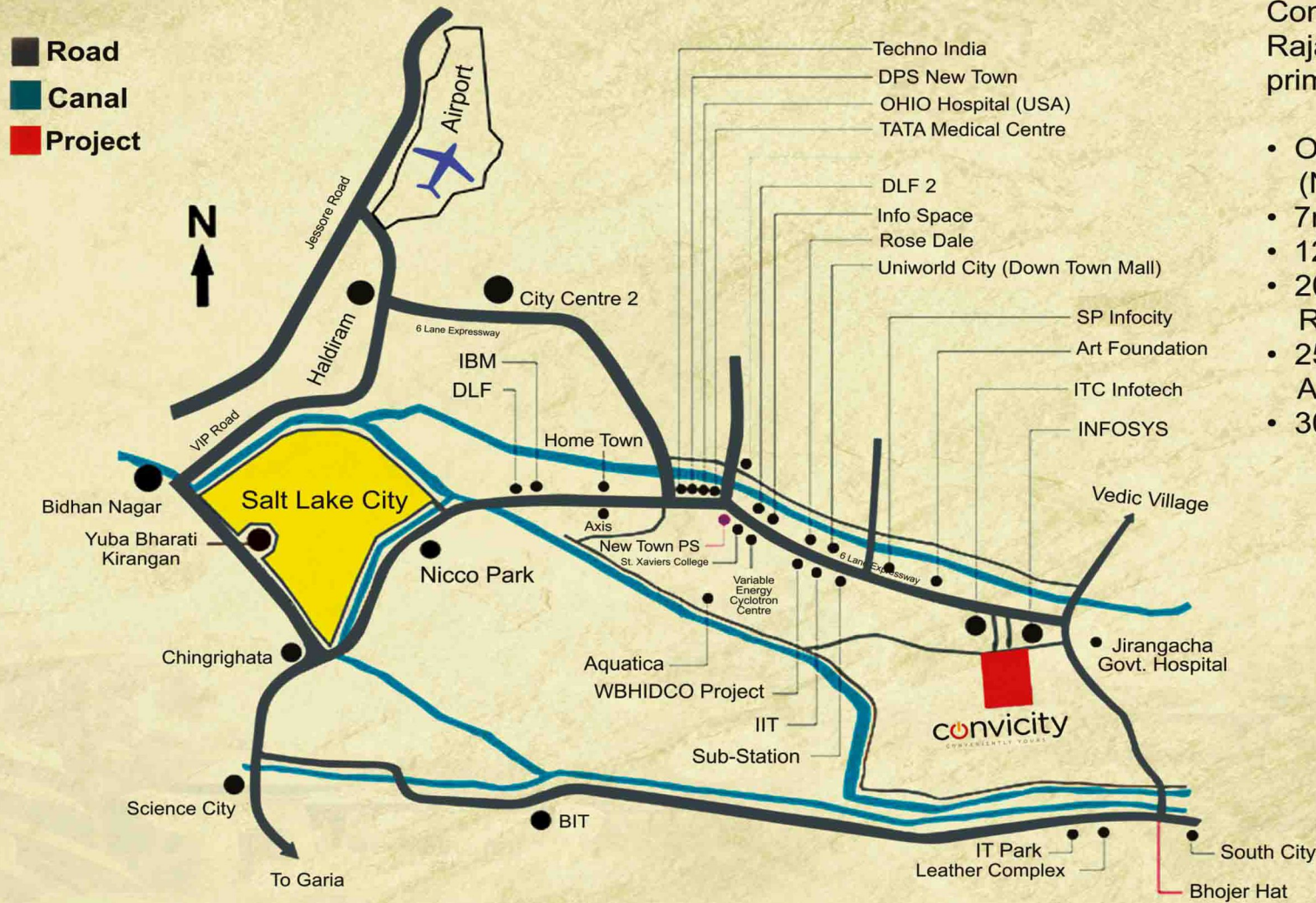

Developed By:

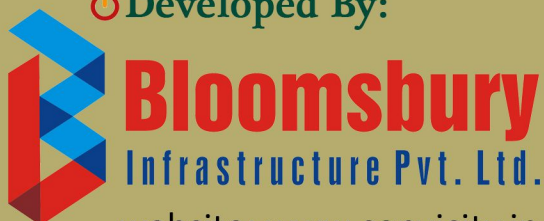

**Bloomsbury**  
Infrastructure Pvt. Ltd.

website: [www.convicity.in](http://www.convicity.in) || email: [info@bloomsburyinfra.in](mailto:info@bloomsburyinfra.in)

The Plans, specifications, images and other details herein are only indicative and the Developer reserves the right to change it. The Developer's website and other advertising materials include Artist's impressions indicating the anticipated appearance of complete development.



Architect:



Convicity  
Walkthrough:



Site Address:

Hatishala, Newtown, AA-III,  
P.S. KLC, Kolkata-700 135.

Corporate Office:

Martin Burn i-Space 1, 3rd Floor,  
DH-6/32, Street No-315,  
Newtown, AA-I, Kolkata-700 156.